

# 3-colour LED Remote Display for Battery Watch

Quick start guide  
V 1

**LEAB**  
mobile energy

It is prohibited to copy, duplicate, translate or otherwise pass on the content of this document to third parties without the express written permission of LEAB.



## We make energy mobile.

### LEAB Automotive GmbH

Thorshammer 6  
24866 Busdorf  
Tel: +49(0) 4621 9 78 60-0  
Fax: +49 (0) 4621 9 78 60-260  
info@leab.eu

### General Safety

This guide supports safe handling of the product. This guide is intended for Skilled workers in the field of automotive electrics. Use the product only in accordance with its intended use:

**The remote display (3-colour LED) shows the operating status of the battery watch BW 801e from LEAB.**

Observe the safety instructions:

**NOTE!** To avoid malfunctions, observe the specified colour arrangement for the cores of the flat cable during installation.

### Package Content

Amount	Item
1 x	3-colour LED
1 x	Metal socket (Ø 5 mm)
1 x	Four-core flat cable (1 m/5 m)

### Technical Data

	Part. no.: 1401036701	Part. no.: 1401036702
Model	3-colour LED	3-colour LED
Cable	Flat modular cable black	Flat modular cable black
Cable length	5 m	1 m
Diameter LED	5 mm	5 mm
Installation depth	20 mm (with LED and cable)	20 mm (with LED and cable)
Dimensions (L x W x H)	6.5 cm x 6 cm x 3 cm	6.5 cm x 6 cm x 3 cm
Weight	0.085 kg	0.085 kg

### Assembly



To assemble the remote display, proceed as follows:

1. Drill a hole (Ø 8 mm) at the assembly point.
  2. Remove the locknut of the metal socket and place it on the flat cable.
  3. Guide the flat cable through the drilled hole.
  4. Place the LED in the metal socket.
  5. Place the metal socket in the drilled hole.
  6. Tighten the locknut.
- ⇒ The remote display is assembled.

### Installation

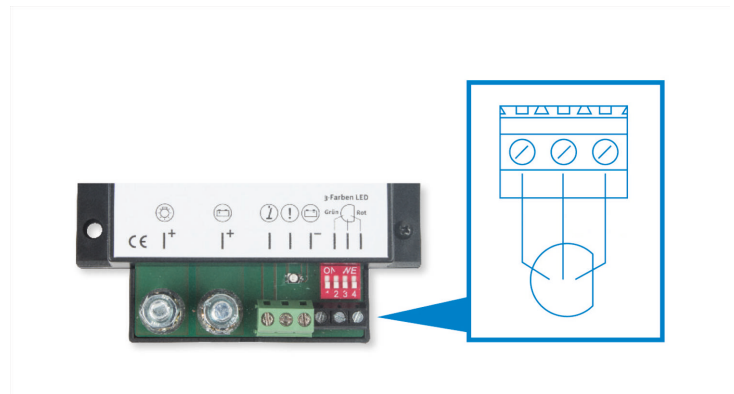

**NOTE!** To avoid malfunctions, observe the specified colour arrangement for the cores of the flat cable during installation.

**NOTE!** The yellow core is not used.

To install the remote display, proceed as follows:

1. Connect the green core (anode) of the flat cable to the "Green" (+) LED connection of the battery watch.
  2. Connect the white core of the flat cable to the LED connection (-) of the battery watch.
  3. Connect the brown core of the flat cable to the LED connection "Red" (+) of the battery watch.
- ⇒ The remote display is installed. The operating status of the battery watch is displayed.

## Operating status

Display	Status
LED lit green	Battery voltage is above the alarm threshold setting, device is active.
LED flashes green	External switch is closed, consumers are switched off.
LED lit orange	<b>Safety level 1:</b> Below alarm threshold. Battery voltage will soon reach the switch-off voltage. <ol style="list-style-type: none"><li>1. Switch the consumers off or charge the battery</li></ol>
LED flashes red	<b>Safety level 2:</b> Below switch-off voltage. Consumers have been disconnected from the battery to avoid deep discharge. <ol style="list-style-type: none"><li>2. To supply consumers again, charge the battery to the switch-on voltage.</li></ol>
LED no colour	Device is switched off or incorrectly installed.

## Disposal



Dispose of the device in accordance with the Waste Electrical and Electronic Equipment Regulations (WEEE).

The system must not be disposed of with household waste. Take it to a recycling point or return it to your point of sale.

## EU Declaration of Conformity



The **Remote Display for Battery Watch (3-colour LED)** complies with the requirements of the following directives:

- 2014/30/EU: EMC
- 2011/65/EU: RoHS